

Robit H4

DTH Hammer TD40/DHD340



- ✓ **Lower fuel consumption**
- ✓ **Best in class performance**
- ✓ **Suitable for all conditions**
- ✓ **12 conversions to choose from**



**Easily convertible for
EVERY rock drilling application**

tel. +358 3 3140 3400 • sales@robitgroup.com • www.robitgroup.com

Follow Robit Plc on our social media channels:     

Robit
FURTHER. FASTER.

DTH hammer for 108 mm / 4 1/4" (SL) - 140 mm (5 1/2") diameter holes (TD40 or DHD340 fitting)
 115 mm / 4 1/2" (HD)

Complete Hammer

Model	Configuration	Pin Type	Part Number	Application	Drill & Blast	Well-Drilling
TD40	HD	FV	MX 2002352	H4 TD40 HD FV MX API 2 3/8IN Reg Pin	■	■
		HF	2002813	H4 TD40 HD FV HF API 2 3/8IN Reg Pin	■	■
	SL	FV	MX 2002353	H4 TD40 HD TL MX API 2 3/8IN Reg Pin	■	■
		HF	2002814	H4 TD40 HD TL HF API 2 3/8IN Reg Pin	■	■
	SL	FV	MX 2002967	H4 TD40 SL FV MX API 2 3/8IN Reg Pin	■	■
		HF	2002972	H4 TD40 SL FV HF API 2 3/8IN Reg Pin	■	■
DHD340	HD	FV	MX 2002974	H4 TD40 SL TL MX API 2 3/8IN Reg Pin	■	■
		HF	2002975	H4 TD40 SL TL HF API 2 3/8IN Reg Pin	■	■
	HD	FV	MX 2002706	H4 DHD340 HD FV MX API 2 3/8IN Reg Pin	■	■
		HF	2003354	H4 DHD340 HD FV HF API 2 3/8IN Reg Pin	■	■
	SL	FV	MX 2002981	H4 DHD340 SL FV MX API 2 3/8IN Reg Pin	■	■
		HF	2003342	H4 DHD340 SL FV HF API 2 3/8IN Reg Pin	■	■

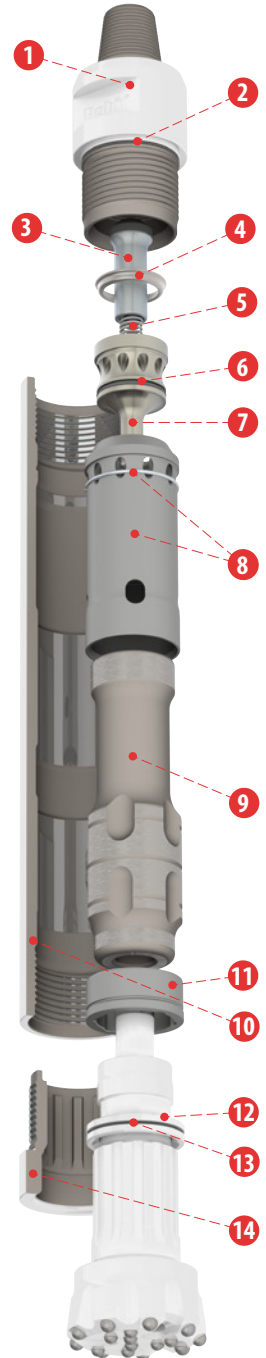

Components

Ref	Description	Part number TD40	Part number DHD340
1	Top adaptor/Backhead HD (SL)	2002340 (2002968)	
2	Backhead O-ring	06M-00-0542	
3	Check valve	2002351	
4	Make up ring	2002341	
5	Check valve spring	06J-25-0544	
6	Air distributor O-ring	06M-00-0541	
7	Air distributor	2002342	
8a	Inner cylinder assembly - MX (Maximum Performance)	2002854	
8b	Inner cylinder assembly - HF (High Efficiency)	2002853	
9	Piston FV, Foot valved (TL, Tubeless)	2002345 (2002346)	2002702
10	Wear sleeve HD (SL)	2002347 (2002969)	
11	Guide bush FV (TL)	2002348 (2002349)	2002698
12	Bit retaining ring assembly (incl. 13, O-ring)	2002350	2002700
13	Bit retaining ring O-ring	06M-00-0543	
14	Chuck HD (SL)	2002518 (2002970)	2002701 (2002978)
	Service kit H4 incl. (2, 5, 6, 13)	2002861	
	Repair kit H4 HD (SL) incl. (2, 3, 4, 5, 6, 12, 14)	2002862 (2003508)	2003355 (2003343)
	Life Kit H4 HD (SL) FV API 2 3/8" Pin incl. (1, 10, 11, 14)	2002825 (2003318)	2003356 (2003344)
	Life Kit H4 HD (SL) TL API 2 3/8" Pin incl. (1, 10, 11, 14)	2002826 (2003509)	-

Air Consumption

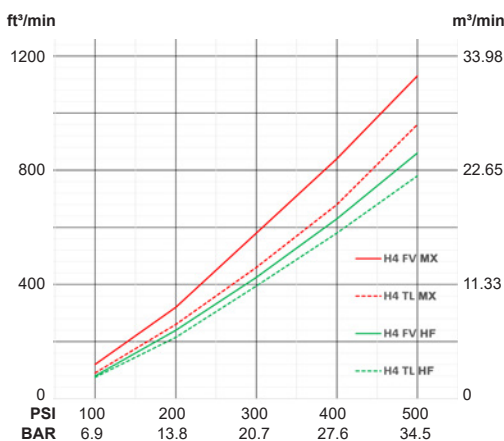

Hammer Specifications

	Imperial	Metric
Weight (HD, less bit)	83.8 lbs	38.0 kg
Weight (SL, less bit)	75.0 lbs	34.0 kg
Length (less bit)	33.86"	860 mm
Outside Dia. (HD)	4.02"	102 mm
Outside Dia. (SL)	3.86"	98 mm
Discard Limit	3.54"	90 mm
Piston Weight (FV)	18.5 lbs	8.4 kg
Piston Weight (TL)	17.9 lbs	8.1 kg

HD = Heavy Duty
 SL = Slim Line
 FV = Foot Valved
 TL = Tubeless
 MX = Maximum Performance
 HF = High Efficiency

Please contact Robit's sales regarding the



DTH hammers: sales@robitgroup.com

