

Robit H8

DTH Hammer QL80/DHD380



- ✓ **Lower fuel consumption**
- ✓ **Best in class performance**
- ✓ **Suitable for all conditions**
- ✓ **12 conversions to choose from**

Robit H8

Further. Faster.

Further. Faster.

EVERY rock drilling application
Easily convertible for

Robit
FURTHER. FASTER.

tel. +358 3 3140 3400 • sales@robitgroup.com • www.robitgroup.com

Follow Robit Plc on our social media channels:



DTH hammer for 203 mm / 8" (SL) - 254 mm (10") diameter holes (QL80 or DHD380 fitting)
 216 mm / 8 1/2" (HD)

Complete Hammer

Series	Model	Configuration	Part Number	Description	Drill & Blast	Well-Drilling
QL80	HD	FV	1281094	H8 QL80 HD FV MX API 4 1/2IN Reg Pin	■	■
		HF	1281096	H8 QL80 HD FV HF API 4 1/2IN Reg Pin	■	■
	SL	FV	2002987	H8 QL80 SL FV MX API 4 1/2IN Reg Pin	■	■
		HF	2002988	H8 QL80 SL FV HF API 4 1/2IN Reg Pin	■	■
	HD	TL	1281093	H8 QL80 HD TL MX API 4 1/2IN Reg Pin	■	■
		HF	1281095	H8 QL80 HD TL HF API 4 1/2IN Reg Pin	■	■
DHD380	HD	FV	1281387	H8 DHD380 HD FV MX API 4 1/2IN Reg Pin	■	■
		HF	1281388	H8 DHD380 HD FV HF API 4 1/2IN Reg Pin	■	■
	SL	FV	1281390	H8 DHD380 SL FV MX API 4 1/2IN Reg Pin	■	■
		HF	1281389	H8 DHD380 SL FV HF API 4 1/2IN Reg Pin	■	■

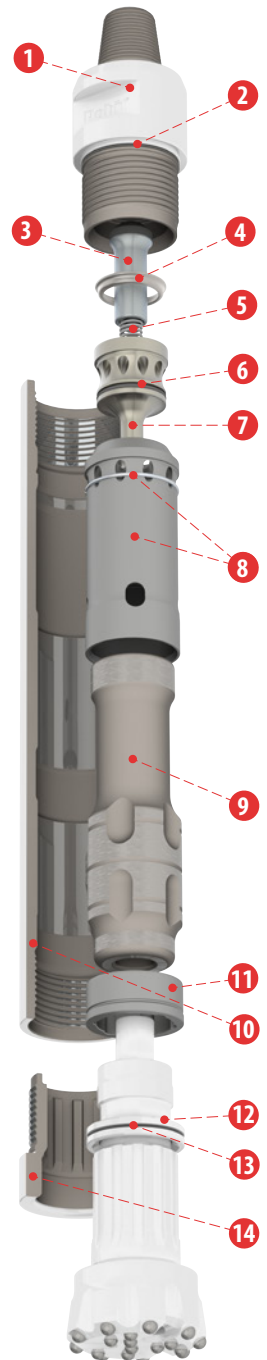

Components

Ref	Description	Part number QL80	Part number DHD380
1	Top adaptor/Backhead HD (SL)	1281108 (2002982)	
2	Backhead O-ring	9003540	
3	Check valve	9003436	
4	Make up ring	1281110	
5	Check valve spring	9003435	
6	Air distributor O-ring	9003542	
7	Air distributor	1281109	
8a	Inner cylinder assembly - MX (Maximum Performance)	1281116	
8b	Inner cylinder assembly - HF (High Efficiency)	1281117	
9	Piston FV, Foot valved (TL, Tubeless)	1281103 (1281102)	1281371
10	Wear sleeve HD (SL)	1281099 (2002983)	
11	Guide bush FV (TL)	1281101 (1281100)	1281372
12	Bit retaining ring assembly (incl. 13, O-ring)	1281107	1281369
13	Bit retaining ring O-ring	1119422	
14	Chuck HD (SL)	1281106 (2002986)	1281370 (1281373)
	Service kit H8 incl. (2, 5, 6, 13)	1281287	
	Repair kit H8 HD (SL) incl. (2, 3, 4, 5, 6, 12, 14)	1281288 (1281340)	1281408 (1281412)
	Life Kit H8 HD (SL) FV API 3 1/2" Pin incl. (1, 10, 11, 14)	1281336 (1281341)	1281410 (1281411)
	Life Kit H8 HD (SL) TL API 3 1/2" Pin incl. (1, 10, 11, 14)	1281289 (1281406)	-

Air consumption

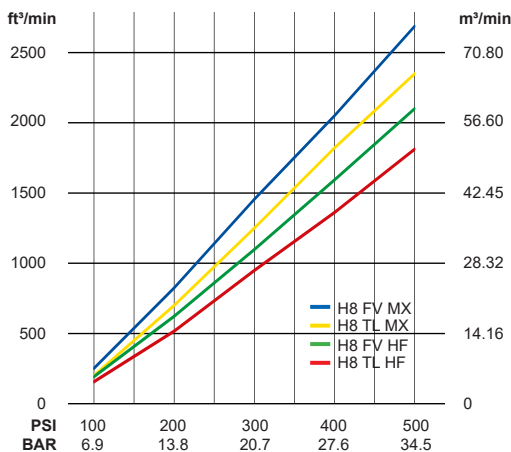

Hammer Specifications

	Imperial	Metric
Weight (HD, less bit)	441.0 lbs	200.0 kg
Weight (SL, less bit)	379.2 lbs	172.0 kg
Length (less bit)	49.02"	1245 mm
Outside Dia. (HD)	7.64"	194 mm
Outside Dia. (SL)	7.24"	184 mm
Discard Limit	6.85"	174 mm
Piston Weight (FV)	103.2 lbs	46.8 kg
Piston Weight (TL)	91.7 lbs	41.6 kg

HD = Heavy Duty
 SL = Slim Line
 FV = Foot Valved
 TL = Tubeless
 MX = Maximum Performance
 HF = High Efficiency

Please contact Robit's sales regarding the



DTH hammers: sales@robitgroup.com

